

Navihood L3

Smart GPS Bike Computer

Quick Start Guide



MENU

1. Safety Warnings and Usage Notes	01
2. App Download	02
3. Package Details	04
4. Installation on Bicycle	05
5. Button Functions	06
6. GPS Working Status	07
7. Startup Process	08
8. Backlight Brightness Adjustment	10
9. Commonly Used Symbols	11
10. Connecting Sensors	12
11. Unit Setting	13
12. Data&Pages Configuration (Hiding/Sorting)	14
13. Menu Setting	15
14. Night Riding Safety Light	17
15. Zone Warning Light	18
16. Type-C Interface and Charging	19
17. Help and After-Sales Service	20



Safety Warnings and Usage Notes

Please pay attention to the following safety precautions

1. The account information and user ID you use when registering is the only information we will use to confirm your legitimate use, so please keep it safe.
2. When you log out of your account or delete a sports record, our server will permanently delete your data, which is an irreversible loss and also a protection of your personal privacy.
3. Since you have agreed to share your data with third-party APP platforms, the data you share through the  to third-party platforms will no longer be under our control, so please pay attention to the security of your data.
4. The following will damage your computer so please avoid these, high temperatures, fire, immersion in water / other liquids. Follow local laws & regulations when disposing of waste items.

2. APP Download

2.1 App Download

1. Scan the right QR Code to download Navihood APP;
2. Download the Navihood APP  in iOS App Store or Google Play and other various Android phone stores.



2.2 App Connectivity to L3 device.

1. Register and log in to the APP, turn on the bluetooth and location allowance.
2. Turn on the L3 and add the computer in our APP→Select L3→start to search→click Connect.

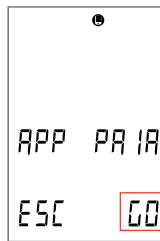
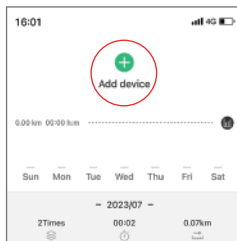

When the computer prompts for pairing, short press the right button  to accept.

3. After pairing has been successful and to ensure a smooth experience, please authorize the app permissions in your phone's settings for phone calls/messages notification, location, camera, storage, and battery by starting management→manual management→allowing background activities. Please update your phone's software to the latest version to avoid any issues.

2.3 APP Detailed Operation Video

For more detailed operational videos, please scan and follow our youtube official account below.



Youtube official account

3. Package Details



Navihood L3 Head Unit * 1pc

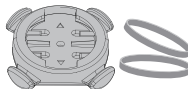

Stem Mount(including fixing rubber bands) * 1pc



Quick User Guide * 1pc



Lanyard * 1pc



Type-C Data Cable * 1pc

4. Installation on Bicycle

4.1 Installation on the stem mount.

- 1 Select a set of rubber bands that are suitable for the diameter of your bike's handlebars and attach the computer mounting bracket diagonally onto the bicycle.
- 2 Align the computer with the insertion port and rotate it 90 degrees to securely attach the computer.

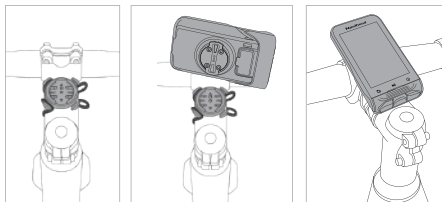

State

A This package does not include a forward extension mounting bracket. You can purchase a suitable forward extension mounting bracket for your bicycle separately according to its structure.

B. To prevent breakage, this computer's mounting bracket base uses a patented metal interface. Please use a bicycle mounting bracket that is of appropriate specifications and has a quality guarantee. Any damage caused by unofficially recognized mounting brackets will be borne by the consumer.

4.1 Installation of the out-front F-mounts. (Purchased separately)

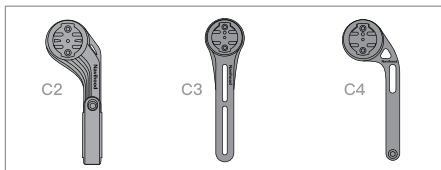

5. Button Functions

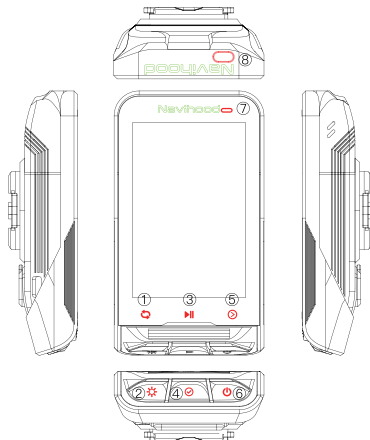

Number	Symbol	Short Press	Long Press
① ②		Record state: Segment	Turn on / off backlight
③ ④		Record state: Start / Pause recording	Record state: Save recording Data Page: Enter the setting
⑤ ⑥		Page Turning	Power on / off
⑦		Zone Warning Light	
⑧		Night Riding Safety Light	

6. GPS Working Status

When the computer has been idle for 4 hours or more, the GPS may take longer than 2 minutes to acquire positioning. You can use the Navihood APP to help in this regard. Please wait for GPS positioning before starting recording otherwise some of your data may not be saved or timing may be incorrect. You can confirm GPS positioning on the following interface below:

This symbol will display when device has GPS signal



! Attention

1. If you find the GPS positioning a bit slow, you can connect the device to Navihood APP, which will help to locate faster.
2. The GPS may not work properly near tall buildings, bridges, tunnels, indoors, etc.

7. Startup Process

1. After GPS is located, you can start riding. Short press ▶|| to start record. When the ride is paused or turned off, the recording is automatically paused. When the ride resumes again, it picks up where it left off.

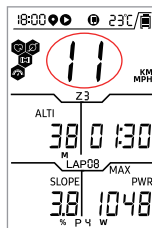

Flashing means workout paused

2. End the ride, long press ▶|| to save the record. When the computer is connected to the APP, the record will be automatically uploaded to the APP. When you begin your next ride, the computer will be restart from zero.



Saving

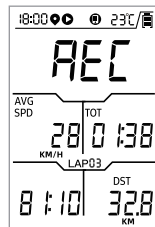

Displayed after saving

- 3 . Short press when recording: 🔄 , The current record is the first segment, and L3 displays the current lap record.

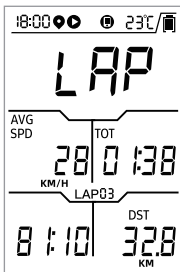

Lap will display for 2 seconds, it will disappear when any button is pressed

8 . Backlight Brightness Adjustment

1. Long press ☀️ to turn on the backlight. Long press ☀️ again to turn off backlight.
- 2 . Backlight brightness: when the APP is connected to L3, Please set it in the basic setting of the APP - Backlight brightness.

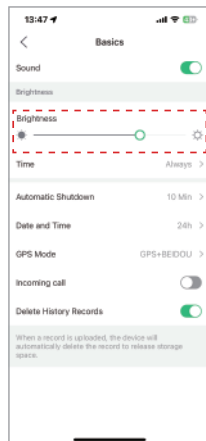
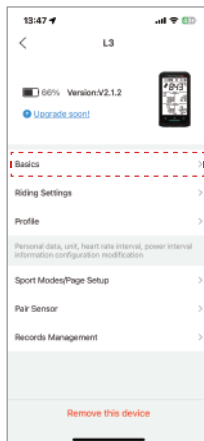

9 . Commonly Used Symbols

	Current time
	GPS Positioning
	Start
	Pause
	App Connectivity
	Temperature
	Power
	Heart Rate Monitor
	Cadence
	Power Meter
	Speed
	Power data intervals

10 . Connecting Sensors

Click "Pair Sensor" in APP - L3 will start searching for sensors. Please pedal the bike to ensure that the sensor is activated. Select the corresponding sensor and add it, ensure the connection is successful. When a speed sensor is connected, you can set the wheel circumference under the sensor menu (you can also select it directly from the model list).

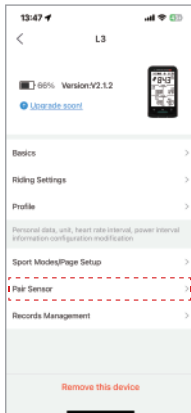

Pair Sensor

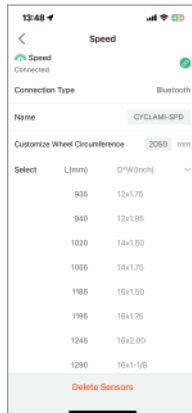

Customize Wheel Circumference

Supported sensors and wireless connectivity methods

Speed	BLE	ANT+
Cadence	BLE	ANT+
Speed & Cadence	BLE	ANT+
Heart Rate Monitor	BLE	ANT+
Power Meter	BLE	ANT+

11. Unit Setting

When the APP is connected to the computer, you can set the unit to metric or imperial by going to "Profile → Unit" in the APP.

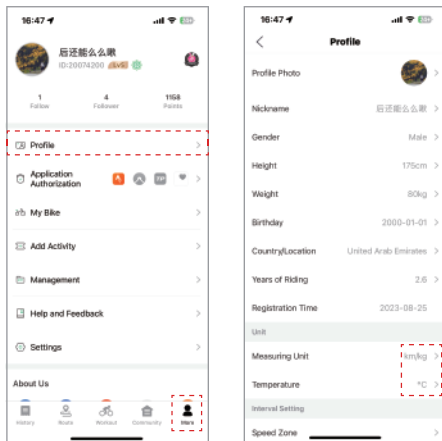

12. Data & Pages Configuration (Hiding/Sorting)

L3 supports up to 10 pages and 27 data field metrics. After connecting the bike computer to the Navihood APP, you can quickly set pages, change data fields, hide pages, drag pages for sorting. This option allows you to fully customise the computer to your usage needs.

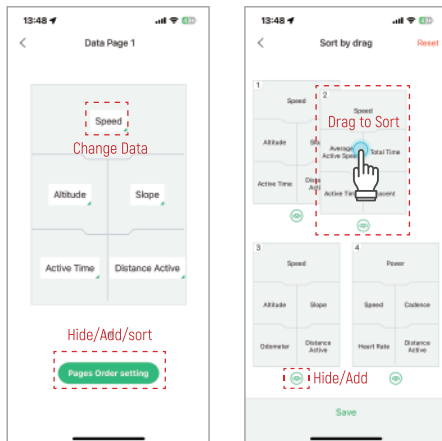

click to change data

hide/close pages drag to sort

13 . Menu Setting

The most convenient way to set up the bike computer is through the APP.

Setting operations on the device:

Non - recording state, long press  enter the setting page.

Metric units setting



Temperature units setting

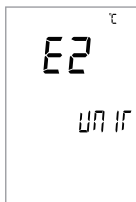

Sound Off



Start Record Reminders



Call Alert



Flash full



Time zone setting
(time correction)

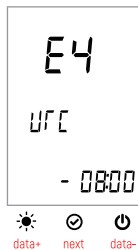

Search Sensors



Setting the wheel
circumference

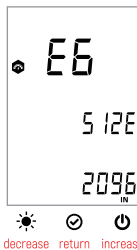

Auto delete



14 . Night Riding Safety Light

L3 has a night riding safety light at the front of the computer shown below. when the device is connected to the APP this can be set to be on / off or flashing. Go to L3 - Riding Settings - Safety Light and Mode.

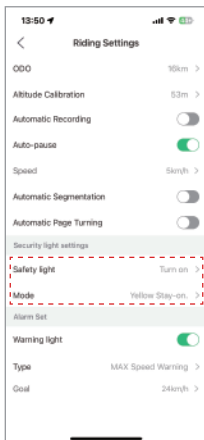
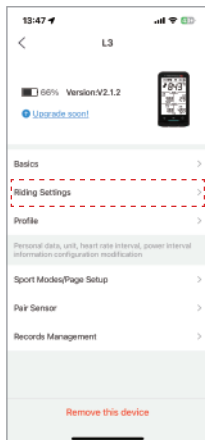

15 . Zone Warning Light

The L3 has a zone warning light in the top right corner of the front of the computer. When the device has been connected to the APP it can be set to be on / off depending on the value that has been input into L3 - Ride Settings - Warning Light, Green light solid for OK, Red light illuminates when warning zone is reached.

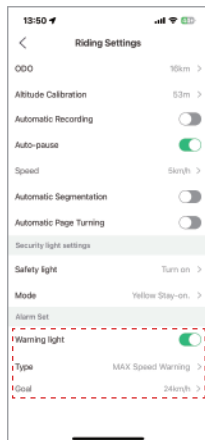
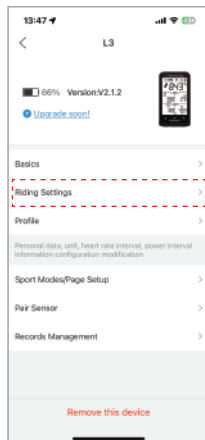

16 . Type-C Interface and Charging

- 1 . The TYPE-C interface of this bicycle computer has a communication function. In the power-off state, you can quickly copy files from a computer.
- 2 . You can charge the computer using a mobile phone charger or a computer USB interface. Maximum input standard: DC 5V, 1A.
- 3 . Turn off the L3 and connect the bike computer to a PC computer with the TYPE-C cable, then the L3 RECORD Mobile Disk  will appear on your PC computer and you can quickly copy the recorded files from the code meter via the cable.



TYPE-C data connection displayed on the bicycle computer

17 . Help and After-Sales Service

This bicycle computer carries a manufacturer's warranty of 2 years from date of purchase. This includes any manufacturing defects but excludes any personal human error.

If you encounter any difficulties during use, you can find us through the following channels:

Troubleshooting guides in various functional sections of the APP. For example, common problems about device-APP connectivity

- ▶ "More→Help Center" in the APP or "Contact Us" on the official website
- ▶ After-sales email: service@meilankj.com
- ▶ Phone: +86 0755 23159119

Working hours: Monday to Friday, 09:00-17:00 China time

- ▶ Navihood official social media accounts:



YouTube



Facebook



Instagram



Tiktok

Manufacturer: Shenzhen Meilan Technology Co., Ltd.

Address: 5th Floor , Building B16, Hengfeng Industrial City, Hezhou, Hangcheng Street, Baoan District, Shenzhen City, Guangdong Province, China

Tel: +86 755 23159119

Declaration:

Navihood

has been registered and legally protected in Japan, South Korea, Canada, the United States, the European Union, and the United Kingdom.



Developed and owned by Garmin Canada Inc., and MEILAN is authorized to use it normally within the validity period.



Owned by the Bluetooth SIG, and MEILAN is authorized to use it in compliant products and sales channels.

Navihood L3

